

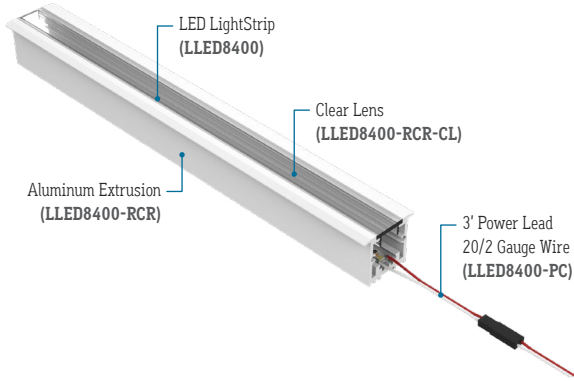

CALIFORNIA  
ACCENT  
LIGHTING  
INC

± 0.15" Tolerance



**FEATURES**

<b>APPLICATIONS</b>	Accent, Decorative, Surface, Recessed, Pendant Lighting
<b>LAMP TYPE</b>	LEDs
<b>CRI</b>	> 85
<b>LENS</b>	Clear, 50% Semi-Frosted, or 100% Frosted
<b>VIEWING ANGLE</b>	15°, 30°, 45°, 60°, 120°, and Asymmetric Optics
<b>MOUNTING</b>	Mounting Channel or Mounting Clips (Sold Separately)
<b>WEIGHT</b>	0.609 lbs per foot
<b>CONSTRUCTION</b>	Aluminum Extrusion
<b>LENGTH</b>	Built to Order
<b>LISTING</b>	Dry, Wet, or IP67 Location UL2108, CSA C22.2 #9 UL8750, CSA250
<b>INSTALLATION</b>	Link to Installation Instructions
<b>ELECTRICAL</b>	
<b>DIMMING</b>	0-10V
<b>MAXIMUM RUN (Based on 5 Amps)</b>	27' (4.3W)
<b>MAXIMUM RUN (Based on 4 Amps for Class II)</b>	22' (4.3W)
<b>VOLTAGE</b>	24VDC
<b>DRIVER</b>	Remote (Sold Separately)
<b>TEMPERATURE RATINGS</b>	Operating / Startup: -20° to 48°C (-4° to 120°F) Storage: -40° to 76°C (-40° to 170°F)

# LLED8400-RCR

ACCENT & COVE

PROJECT

TYPE



SINGLE BIN  
+/-30K



**LIGHTSTRIP, EXTRUSION, & LENS**

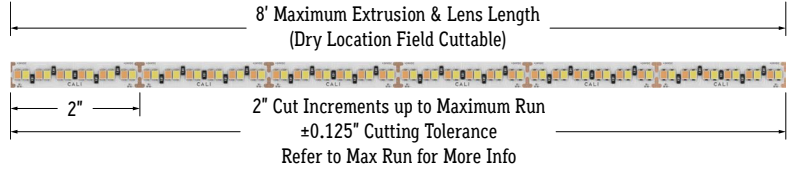

**LENS**

Clear Lens Visible Diode Image (CL)	50% Semi-Frosted Lens Slight Diode Image (SF)	100% Frosted Lens No Diode Image (Line of Light) (F)	Optic & Asymmetric Lens Slight Diode Image (ASM, 15D, 30D, 45D, 60D)

**BEAM ANGLES**

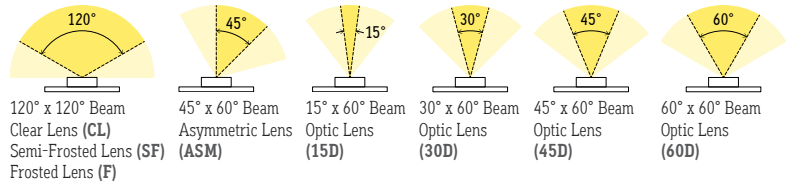

**END VIEW**

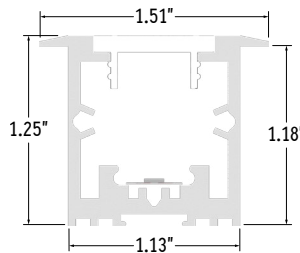

**LIGHT LOSS FACTORS**

LENS / OPTIC	EFFICACY LOSS
Clear (CL)	0%
50% Semi-Frosted (SF)	12.5%
Optic (ASM, 15D, 30D, 45D, 60D)	18%
100% Frosted (F)	25%

SERIES	LENS / OPTICS	WATTS PER FOOT	DIMMING	CCT LED	LISTING	FINISH	FIXTURE LENGTH
LLED8400-RCR	-	4.3W	-	DW	-	-	-
LLED8400-RCR	Clear Lens (CL)	4.3 Watts (4.3W)	0-10V: 100% - 1% (10V-1%)	Dim to Warm 3000K - 1800K (DW)	Indoor (DRY)	Natural Silver* <sup>3</sup> (NA) Polished (PA)	Specify Length in Feet & Inches Example: 7'8"
	50% Semi-Frosted Lens (SF)	To calculate Lumens per Foot, multiply Efficacy by Wattage. <b>Example:</b> 4.3W x 92 Lm/W = 395 Lm/Ft			Outdoor* <sup>2</sup> (WET)	White (WH) Satin / Silver (SA)	
	100% Frosted Lens: Line of Light (F)				Outdoor IP67* <sup>2</sup> (IP67)	Black (BK)	
	Asymmetric Lens (ASM)						
	15°* <sup>1</sup> (15D)						
	30°* <sup>1</sup> (30D)						
	45°* <sup>1</sup> (45D)						
	60°* <sup>1</sup> (60D)						

\*<sup>1</sup> Add 0.14" to overall height is using 15°, 30°, 45°, or 60° optics

\*<sup>2</sup> Run lengths required for Wet Location & IP67 products

\*<sup>3</sup> Standard Finish: Natural Silver if left blank

**CALIFORNIA ACCENT LIGHTING, INC.**

2820 E. Gretta Lane, Anaheim, CA 92806

ph. 800.921.CALI (2254) | fx. 714.535.7902 | info@calilighting.com | calilighting.com

© CALI. All rights reserved. CALI reserves the right to make changes or withdraw specifications without prior notice.





CALIFORNIA  
ACCENT  
LIGHTING  
INC

# LLED8400-RCR | ACCENT & COVE

## ACCESSORIES (Sold Separately)



Power Connector Dry (20/2 Gauge Wire)  
LLED8400-PC (33" Standard)  
LLED8400-PC-X (X = Specify Length)

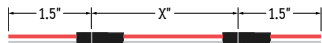

Continuous Connector Dry (20/2 Gauge Wire)  
LLED8400-CC (3" Standard)  
LLED8400-CC-X (X = Specify Length)

**Note:** Connector type subject to change without notice  
**Note:** Connectors available with black or white jacket.  
Click on image to see cut sheet for details.

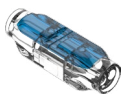

Wet Splice Connector  
(LLED8400-SC-WET)

## MOUNTING OPTIONS (Sold Separately)

Click image to view installation information

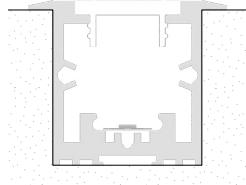

Recessed Mount

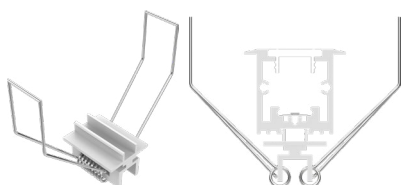

Spring Mounting Clip  
(LLED8400-RCR-SPR-MC)

## LAMP SPECIFICATIONS

LAMP NUMBER	CORRELATED COLOR TEMPERATURE @ DIMMING %	EFFICACY (LUMENS / WATT)	L70 LED LIFE
DW	1900K @ 25%	148	60,000 hrs
	2000K @ 50%	137	
	2500K @ 75%	118	
	3000K @ 100%	92	

PART NUMBER	WEIGHT	SPECIFY FINISH	SPECIFY LENGTH	SPECIFY QUANTITY	UNIT
LLED8400-CC-X*	Varies by Length				Each
LLED8400-PC-X*	Varies by Length				Each
LLED8400-SC-WET	0.009 lbs each	N/A	N/A		Each
LLED8400-RCR-SPR-MC	0.048 lbs	N/A	N/A		Each

\*Leave blank for Standard option

## DESIGN GUIDELINES

Individual Fixture (Up to 8')

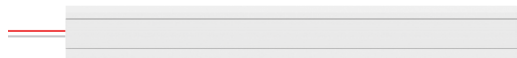

Runs with Continuous Connector

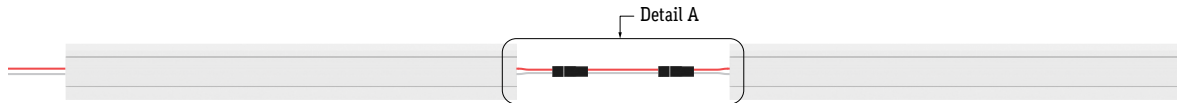

Continuous Run (Dry Location)

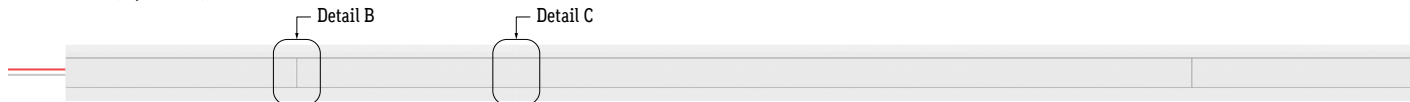

Continuous Run (Wet Location)

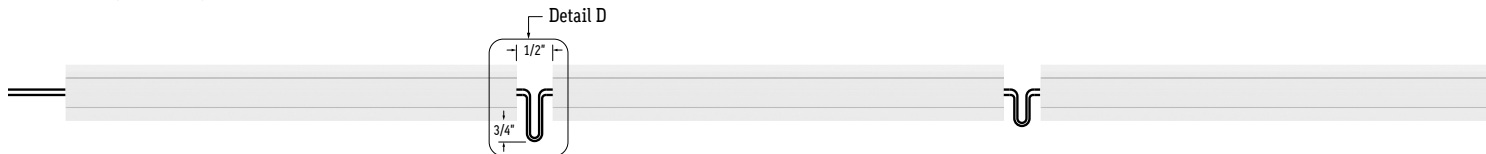

Detail A  
Continuous Connector  
(LLED8400-CC)



Detail B  
Two Lenses Meet  
(Dry Location)



Detail C  
Continuous Connection  
(Dry Location)



Detail D  
Continuous Connection  
(Wet Location)

CALIFORNIA ACCENT LIGHTING, INC.

2820 E. Gretta Lane, Anaheim, CA 92806

ph. 800.921.CALI (2254) | fx. 714.535.7902 | info@calilighting.com | calilighting.com

© CALI. All rights reserved. CALI reserves the right to make changes or withdraw specifications without prior notice.

