

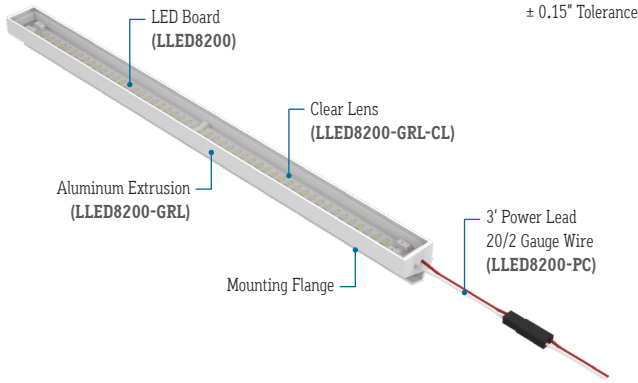

CALIFORNIA
ACCENT
LIGHTING
INC

LLED8200-GRL

ACCENT
& COVE



PROJECT

TYPE



SINGLE
BIN
+30K



- ✓ TM-30
- ✓ LM-79
- ✓ LM-80



LED BOARD, EXTRUSION, & LENS

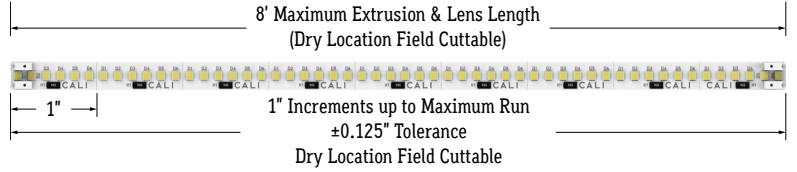

LENS



Clear Lens
Visible Diode Image
(CL)



50% Semi-Frosted Lens
Slight Diode Image
(SF)



100% Frosted Lens
No Diode Image (Line of Light)
(F)

LIGHT LOSS FACTORS

LENS	EFFICACY LOSS
Clear (CL)	0%
50% Semi-Frosted (SF)	12.5%
100% Frosted (F)	25%

Example: 3.0K CCT LED with Frosted Lens. 25% of 108 is 27. 108 - 27 = 81. The Efficacy of 3.0K CCT LED with Frosted Lens is 81.

END VIEW

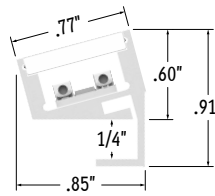

Clear Lens (CL)
50% Semi-Frosted Lens (SF)
100% Frosted Lens (F)

MOUNTING OPTION

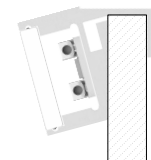

1/4" Glass Mount
(Dry or Wet Location)

FEATURES

APPLICATIONS	Direct View, Accent, Decorative Lighting
LAMP TYPE	LEDs
CRI	> 90
LENS	Clear, 50% Semi-Frosted, or 100% Frosted
VIEWING ANGLE	120°
MOUNTING	Glass Mount (Adhesive)
WEIGHT	0.255 lbs per foot
CONSTRUCTION	Aluminum Extrusion
LENGTH	Built to Order

LISTING	Dry or Wet Location UL2108, CSA C22.2 #9 UL8750, CSA250
----------------	---

INSTALLATION	Link to Installation Instructions
---------------------	-----------------------------------

ELECTRICAL	
DIMMING	Forward Phase, 0-10V, Lutron, DALI

MAXIMUM RUN (Based on 5 Amps)	20' (6W), 30' (4W), 36' (3W, 2W)
--	----------------------------------

MAXIMUM RUN (Based on 4 Amps for Class II)	14' (6W), 24' (4W), 32' (3W), 36' (2W)
---	--

VOLTAGE	24VDC
----------------	-------

DRIVER	Remote (Sold Separately)
---------------	--------------------------

TEMPERATURE RATINGS	Operating / Startup: -20° to 48°C (-4° to 120°F) Storage: -40° to 76°C (-40° to 170°F)
----------------------------	---

SERIES	LENS / OPTICS	WATTS PER FOOT	DIMMING	CCT LED	LISTING	FINISH	FIXTURE LENGTH
LLED8200-GRL	-	-	-	-	-	-	-
LLED8200-GRL	Clear Lens (CL)	2 Watts: 216 Lumens/ft (2W) 3 Watts: 324 Lumens/ft (3W)	Forward Phase (DM) 0-10V: 100% - 10% (10V)	2400K (2.4K) 2700K (2.7K)	Indoor (DRY)	Natural Silver*1 (NA) Polished (PA)	Specify Length in Feet & Inches Example: 7'8"
	50% Semi-Frosted Lens (SF)	4 Watts: 432 Lumens/ft (4W) 6 Watts: 648 Lumens/ft (6W)	0-10V: 100% - 1% (10V-1%) Hi-Lume 1% 2 Wire*2 (2 Wire)	3000K (3.0K) 3500K (3.5K)	Outdoor*5 (WET)	White (WH) Satin / Silver (SA)	
	100% Frosted Lens: Line of Light (F)		Hi-Lume 1% 3 Wire*3 (3 Wire) Hi-Lume Premier 0.1%*4 (L3D0)	4000K (4.0K) 4500K (4.5K)		Black (BK)	
			JA8 0-10V (JA8-10V)	5000K (5.0K)			
			JA8 2 Wire (JA8-2WR)	5700K (5.7K)			
			DALI (DALI)	Red (R)			
			Leave Blank for Non-Dimming	Green (G)			
				Blue (B)			
				Amber (A)			

*1 Standard Finish: Natural Silver if left blank

*2 40 watt max Hi-Lume 1% LTEA2W #LTEA4U1UKL-CV240

*3 40 watt max Hi-Lume 1% L3DA3W #L3DA4U1UKL-CV240

*4 96 watt max Hi-Lume Premier 0.1% #L3D0-96W24V-U

*5 Run lengths required for Wet Location & IP67 products

CALIFORNIA ACCENT LIGHTING, INC.

2820 E. Gretta Lane, Anaheim, CA 92806

ph. 800.921.CALI (2254) | fx. 714.535.7902 | info@calilighting.com | calilighting.com

© CALI. All rights reserved. CALI reserves the right to make changes or withdraw specifications without prior notice.





CALIFORNIA
ACCENT
LIGHTING
INC

LLED8200-GRL

ACCENT
& COVE

ACCESSORIES (Sold Separately)



Power Connector Dry (20/2 Gauge Wire)
LLED8200-PC (33" Standard)
LLED8200-PC-X (X = Specify Length)

Note: Connector type subject to change without notice
Note: Connectors available with black or white jacket.
Click on image to see cut sheet for details.

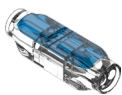

Wet Splice Connector
(LLED8200-SC-WET)

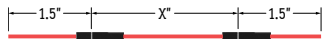

Continuous Connector Dry (20/2 Gauge Wire)
LLED8200-CC (3" Standard)
LLED8200-CC-X (X = Specify Length)



Left End Cap
(LLED8200-GRL-ECL)



Right End Cap
(LLED8200-GRL-ECR)



Channel Clip
(LLED8200-GRL-CP)

LAMP SPECIFICATIONS

LAMP NUMBER	CORRELATED COLOR TEMPERATURE	EFFICACY (LUMENS / WATT)	JA8	L70 LED LIFE
2.4K	2400K Incandescent White	108	Yes	60,000 hrs.
2.7K	2700K Warm White	108	Yes	60,000 hrs.
3.0K	3000K Warm White	108	Yes	60,000 hrs.
3.5K	3500K Neutral White	108	Yes	60,000 hrs.
4.0K	4000K Neutral White	108	Yes	60,000 hrs.
4.5K	4500K Neutral White	108	No	60,000 hrs.
5.0K	5000K Cool White	108	No	60,000 hrs.
5.7K	5700K Cool White	108	No	60,000 hrs.
R	Red (621 nm)	70	No	40,000 hrs.
G	Green (525 nm)	139	No	40,000 hrs.
B	Blue (470 nm)	40	No	40,000 hrs.
A	Amber	128	No	40,000 hrs.

Consult factory for cooler white color temperatures.

PART NUMBER	WEIGHT	SPECIFY FINISH	SPECIFY LENGTH	SPECIFY QUANTITY	UNIT
LLED8200-CC-X*	Varies by Length				Each
LLED8200-PC-X*	Varies by Length		N/A		Each
LLED8200-SC-WET	0.009 lbs each	N/A	N/A		Each
LLED8200-GRL-ECL			N/A		Each
LLED8200-GRL-ECR			N/A		Each
LLED8200-GRL-CP		N/A	N/A		Each

*Leave blank for Standard option.

DESIGN GUIDELINES

Individual Fixture (Up to 8')

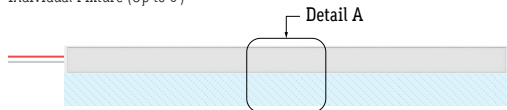

Runs with Continuous Connector

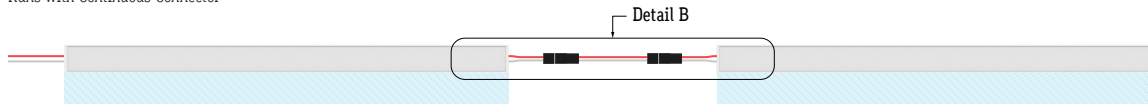

Continuous Run (Dry Location)

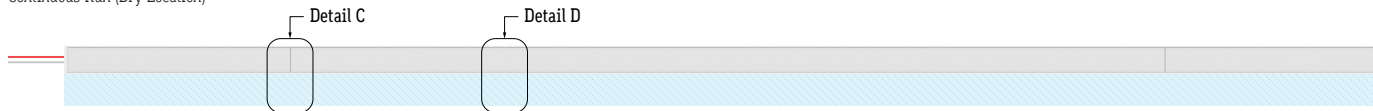

Continuous Run (Wet Location)

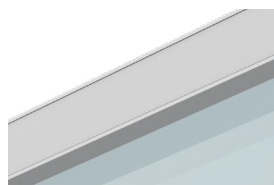
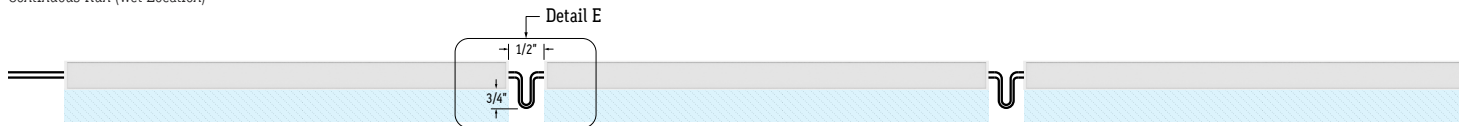

Detail A
1/4" Glass Mount
(LLED8200-GRL)

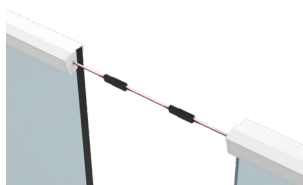

Detail B
Continuous Connector
(LLED8200-CC)

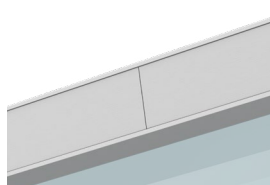

Detail C
Two Lenses Meet
(Dry Location)

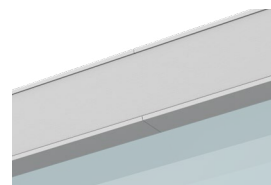

Detail D
Continuous Connection
(Dry Location)

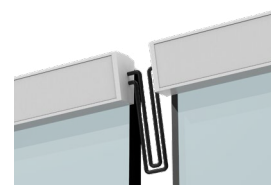

Detail E
Continuous Connection
(Wet Location)

CALIFORNIA ACCENT LIGHTING, INC.

2820 E. Gretta Lane, Anaheim, CA 92806

ph. 800.921.CALI (2254) | fx. 714.535.7902 | info@calilighting.com | calilighting.com

© CALI. All rights reserved. CALI reserves the right to make changes or withdraw specifications without prior notice.

