

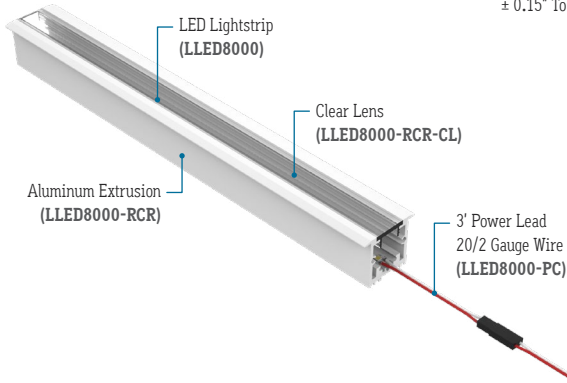

CALIFORNIA  
ACCENT  
LIGHTING  
INC

± 0.15" Tolerance



**FEATURES**

<b>APPLICATIONS</b>	Accent, Decorative, Surface, Recessed, Pendant Lighting
<b>LAMP TYPE</b>	LEDs
<b>CRI</b>	> 95
<b>LENS</b>	Clear, 50% Semi-Frosted, or 100% Frosted
<b>VIEWING ANGLE</b>	15°, 30°, 45°, 60°, 120°, and Asymmetric Optics
<b>MOUNTING</b>	Mounting Channel or Mounting Clips (Sold Separately)
<b>WEIGHT</b>	0.609 lbs per foot
<b>CONSTRUCTION</b>	Aluminum Extrusion
<b>LENGTH</b>	Built to Order
<b>LISTING</b>	Dry, Wet, or IP67 Location UL2108, CSA C22.2 #9 UL8750, CSA250
<b>INSTALLATION</b>	Link to Installation Instructions
<b>ELECTRICAL</b>	
<b>DIMMING</b>	Forward / Reverse Phase, 0-10V, Lutron, DMX, DALI
<b>MAXIMUM RUN (Based on 5 Amps)</b>	18' (6.5W), 21' (5.5W), 26' (4.5W), 33' (3.6W), 36' (1.5W, 2.5W)
<b>MAXIMUM RUN (Based on 4 Amps for Class II)</b>	14' (6.5W), 17' (5.5W), 21' (4.5W), 26' (3.6W), 36' (1.5W, 2.5W)
<b>VOLTAGE</b>	24VDC
<b>DRIVER</b>	Remote (Sold Separately)
<b>TEMPERATURE RATINGS</b>	Operating / Startup: -20° to 48°C (-4° to 120°F) Storage: -40° to 76°C (-40° to 170°F)

# LLED8000-RCR

ACCENT  
& COVE

**PROJECT**



SINGLE  
BIN  
+/-30K



✓ **TM-30**  
✓ **LM-79**  
✓ **LM-80**



**LIGHTSTRIP, EXTRUSION, & LENS**

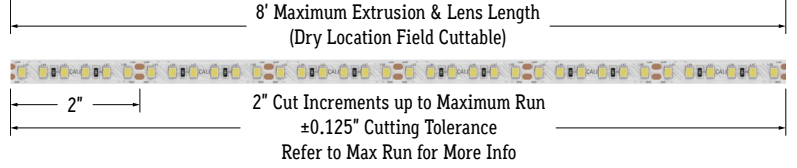

**LENS**

Clear Lens Visible Diode Image (CL)	50% Semi-Frosted Lens Slight Diode Image (SF)	100% Frosted Lens No Diode Image (Line of Light) (F)	Optic & Asymmetric Lens Slight Diode Image (ASM, 15D, 30D, 45D, 60D)

**BEAM ANGLES**

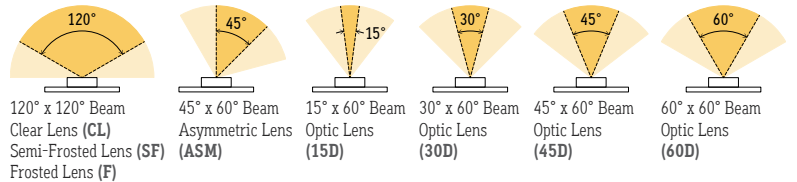

**END VIEW**

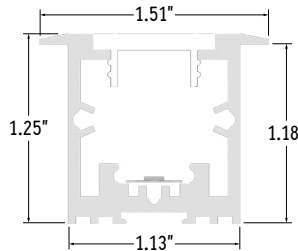

**LIGHT LOSS FACTORS**

LENS / OPTIC	EFFICACY LOSS
Clear (CL)	0%
50% Semi-Frosted (SF)	12.5%
Optic (15D, 30D, 45D, 60D)	18%
100% Frosted (F)	25%

**Example:** 3.0K CCT LED with Frosted Lens. 25% of 100 is 25. 100 - 25 = 75. The Efficacy of 3.0K CCT LED with Frosted Lens is 75.

SERIES	LENS / OPTICS	WATTS PER FOOT	DIMMING	CCT LED	LISTING	FINISH	FIXTURE LENGTH
LLED8000-RCR	-	-	-	-	-	-	-
LLED8000-RCR	Clear Lens (CL)	1.5 Watts (1.5W)	Forward / Reverse Phase (PH)	2400K (2.4K)	Indoor (DRY)	Natural Silver* <sup>1</sup> (NA)	Specify Length in Feet & Inches
	50% Semi-Frosted Lens (SF)	2.5 Watts (2.5W)	0-10V: 100% - 1% (10V)	2700K (2.7K)		Polished (PA)	<b>Example: 7'8"</b>
		3.6 Watts (3.6W)	Hi-Lume 1% 2 Wire* <sup>2</sup> (LTEA)	3000K (3.0K)	Outdoor* <sup>8</sup> (WET)	White (WH)	
	100% Frosted Lens: Line of Light (F)	4.5 Watts (4.5W)	Hi-Lume 1% 3 Wire* <sup>3</sup> (L3DA)	3500K (3.5K)		Satin / Silver (SA)	
		5.5 Watts (5.5W)	Hi-Lume Premier 0.1% JA8* <sup>4</sup> (L3D0)	4000K (4.0K)	Outdoor IP67* <sup>9</sup> (IP67)	Black (BK)	
	Asymmetric Lens (ASM)	6.5 Watts (6.5W)	JA8 0-10V (JA8-10V)	4500K (4.5K)			
	15°* <sup>9</sup> (15D)	To calculate Lumens per Foot, multiply Efficacy by Wattage. <b>Example:</b> 2.5W x 100 Lm/W = 250 Lm/Ft	JA8 Hi-Lume 1% 2 Wire (JA8-LTEA)	Amber* <sup>7</sup> (A)			
	30°* <sup>9</sup> (30D)		DMX-512* <sup>5</sup> (DMX)	Red* <sup>7</sup> (R)			
	45°* <sup>9</sup> (45D)		DALI* <sup>6</sup> (DALI)	Green* <sup>7</sup> (G)			
	60°* <sup>9</sup> (60D)		Leave Blank for Non-Dimming	Blue* <sup>7</sup> (B)			

\*1 Standard Finish: Natural Silver if left blank

\*2 (LTEA) 40 watt max Lutron Hi-Lume 1% 2 Wire #LTEA4U1UKL-CV240

\*3 (L3DA) 40 watt max Lutron Hi-Lume 1% 3 Wire #L3DA4U1UKL-CV240

\*4 (L3D0) 96 watt max Hi-Lume Premier 0.1% #L3D0-96W24V-U

\*5 Consult third party DMX commissioner to modify at time of installation.

\*6 DALI commissioning to be performed by a third party. CALI does not provide DALI commissioning.

\*7 Amber, Red, Green, and Blue LEDs only available in 2.5W and 5.5W

\*8 Run lengths required for Wet Location & IP67 products

\*9 Add 0.14" to overall height if using 15°, 30°, 45°, or 60° optics

**CALIFORNIA ACCENT LIGHTING, INC.**

2820 E. Gretta Lane, Anaheim, CA 92806

ph. 800.921.CALI (2254) | fx. 714.535.7902 | info@calilighting.com | calilighting.com

© CALI. All rights reserved. CALI reserves the right to make changes or withdraw specifications without prior notice.





CALIFORNIA  
ACCENT  
LIGHTING  
INC

# LLED8000-RCR | ACCENT & COVE

## ACCESSORIES (Sold Separately)



Power Connector Dry (20/2 Gauge Wire)  
LLED8000-PC (33" Standard)  
LLED8000-PC-X (X = Specify Length)

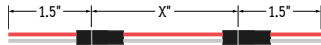

Continuous Connector Dry (20/2 Gauge Wire)  
LLED8000-CC (3" Standard)  
LLED8000-CC-X (X = Specify Length)

**Note:** Connector type subject to change without notice  
**Note:** Connectors available with black or white jacket.  
Click on image to see cut sheet for details.

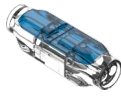

Wet Splice Connector  
(LLED8000-SC-WET)

## MOUNTING OPTIONS (Sold Separately)

Click image to view installation information

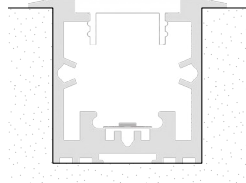

Recessed Mount

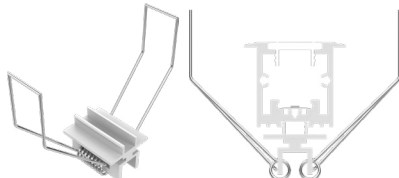

Spring Mounting Clip  
(LLED8000-RCR-SPR-MC)

## LAMP SPECIFICATIONS

LAMP NUMBER	CORRELATED COLOR TEMPERATURE	EFFICACY (LUMENS / WATT)	JA8	L70 LED LIFE
2.4K	2400K Incandescent White	90	Yes	60,000 hrs.
2.7K	2700K Warm White	101	Yes	60,000 hrs.
3.0K	3000K Warm White	100	Yes	60,000 hrs.
3.5K	3500K Neutral White	103	Yes	60,000 hrs.
4.0K	4000K Neutral White	105	Yes	60,000 hrs.
4.5K	4500K Neutral White	102	No	60,000 hrs.
R	Red (621nm)	70	No	40,000 hrs.
G	Green (525nm)	139	No	40,000 hrs.
B	Blue (470nm)	40	No	40,000 hrs.
A	Amber	128	No	40,000 hrs.

Consult factory for cooler white color temperatures.

PART NUMBER	WEIGHT	SPECIFY FINISH	SPECIFY LENGTH	SPECIFY QUANTITY	UNIT
LLED8000-CC-X*	Varies by Length				Each
LLED8000-PC-X*	Varies by Length				Each
LLED8000-SC-WET	0.009 lbs each	N/A	N/A		Each
LLED8000-RCR-SPR-MC		N/A	N/A		Each

\*Leave blank for Standard option

## DESIGN GUIDELINES

Individual Fixture (Up to 8')

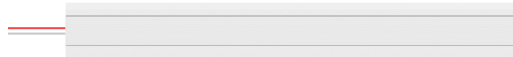

Runs with Continuous Connector

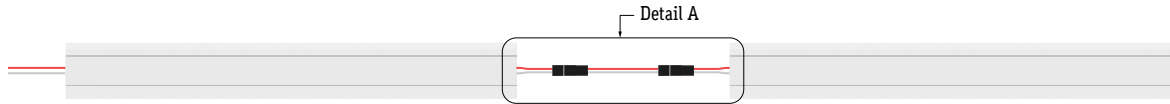

Continuous Run (Dry Location)

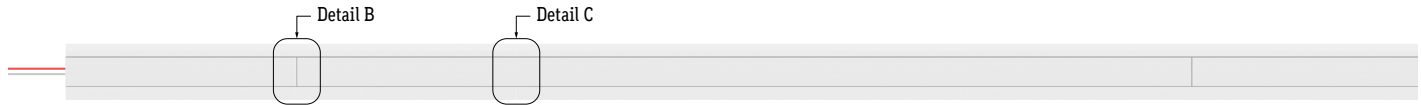

Continuous Run (Wet Location)



Detail A  
Continuous Connector  
(LLED8000-PC)



Detail B  
Two Lenses Meet  
(Dry Location)



Detail C  
Continuous Connection  
(Dry Location)



Detail D  
Continuous Connection  
(Wet Location)

## CALIFORNIA ACCENT LIGHTING, INC.

2820 E. Gretta Lane, Anaheim, CA 92806  
ph. 800.921.CALI (2254) | fx. 714.535.7902 | info@calilighting.com | calilighting.com

© CALI. All rights reserved. CALI reserves the right to make changes or withdraw specifications without prior notice.

