

Isometric View

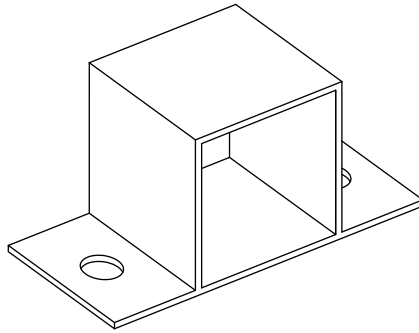

Top View

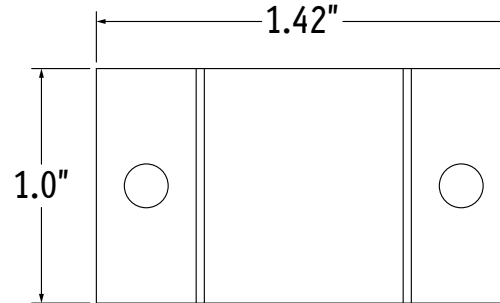

End View

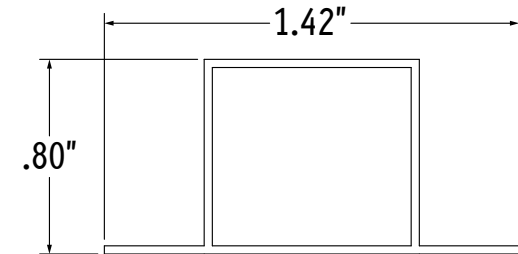

1. Measure area where LLED8500 will be installed.

RECOMMENDATION: Use chalk line to ensure a straight installation.

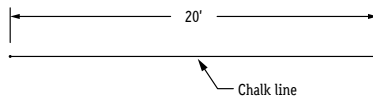

2. Mark location where mounting clips will be installed.

TIP: Quantity of mounting clips = quantity of fixture +1.

Use a mounting clip at the joint between two fixtures.

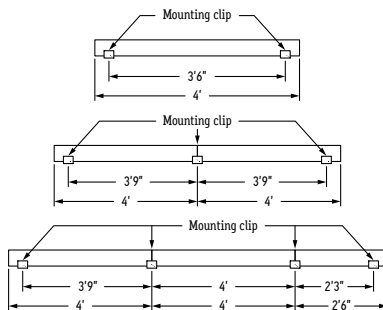

3. Slide required amount of mounting clips onto tube and position fixture in place along chalk line.

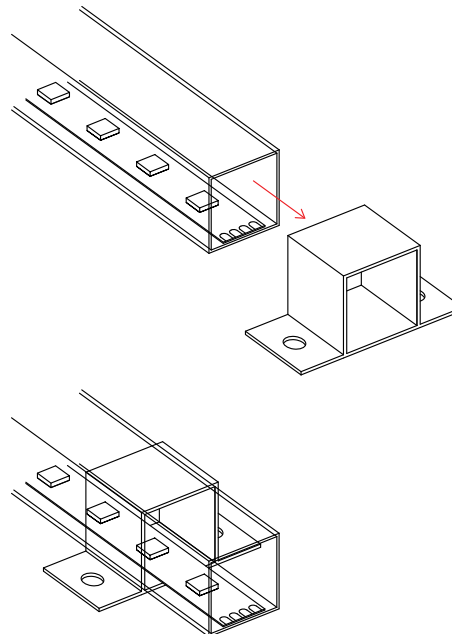

3. Mark location of holes and pre-drill using proper drill bit for surface and screw size, then screw mounting clips to surface.

RECOMMENDATION: 8/32 X 1" screw

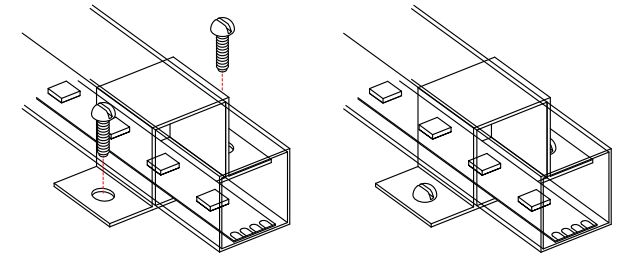

4. Apply silicone at both ends of each run to seal fixture.

Assembled End View

