

FEATURES

APPLICATIONS	Accent, Linear Lighting
VOLTAGE	120V
SOCKET BASE	Medium Base
LENGTH	Built to Order
HOUSING	Aluminum Extrusion
LISTING	Dry or Wet Location UL1598, CSA C22.2#250.0 UL8750, CSA250 UL2108, CSA C22.2 #9
LAMPS	LED Lamps (Included) Incandescent Lamps (Not Included)
OPTIONS	Receptacles or Switches

APPLICATIONS

Designed for indoor applications, *alumLITE* is ideal for many applications including the amusement, recreation, and architectural industries. *alumLITE* is used in: Restaurants, Casinos, Street Decorations, Amusement Parks, Shopping Malls, Promenades, and many more.

TYPICAL ACCESSORIES (Not Included)

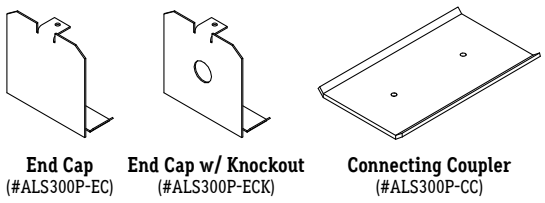

NOT TO SCALE

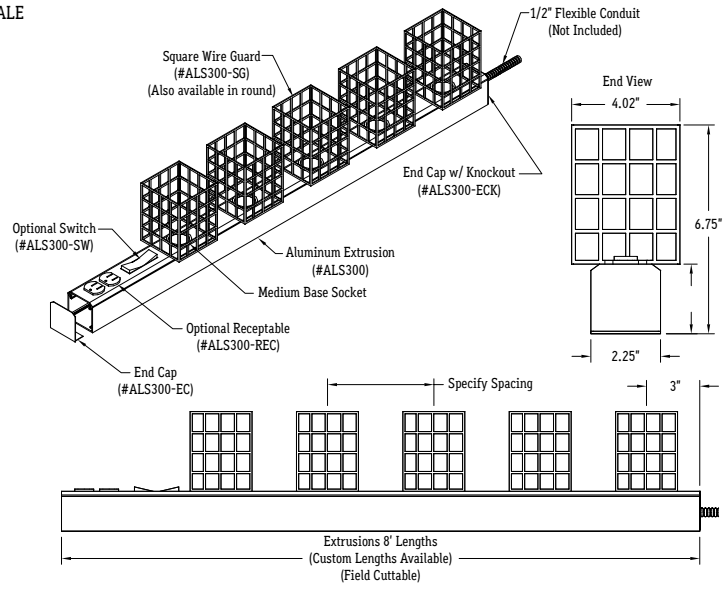

SERIES OPTIONS

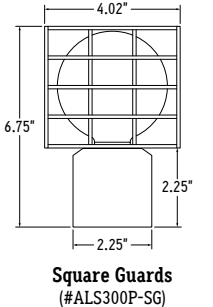

SPECIFY PRODUCT CODE (Use drop down menu to complete table or fill in the blanks)

ALS300P-SG

SERIES	SPACING	LAMP		LISTING	DIMMING	FINISH	OPTIONAL
<i>Ex. ALS300P-SG</i>	12"O/C	2.7K-GSFW		DRY	DM	NA	RG
ALS300P-SG (Square Guards)	4"O/C*	2.7K-GSF	G-GSFW (Green)	Indoor (DRY)	Forward Phase (DM)	Natural Silver (NA)	Receptacle (REC)
	6"O/C	5.0K-GSF	2.4K-GSFL		Outdoor (WET)	Leave Blank for Non-Dimming	Satin (SA)
	8"O/C	A-GSF (Amber)	2.7K-GSFL	White (WH)			Receptacle & Switch (REC-SW)
	9"O/C	R-GSF (Red)	3.0K-GSFL	Anodized Chrome (AC)		Leave Blank for No Additions	
	12"O/C	G-GSF (Green)	5.0K-GSFL	Anodized Black (AB)			
		2.7K-GSFW	2.4K-GSFLW			Anodized Gold (AG)	
		5.0K-GSFW	2.7K-GSFLW			Anodized Bronze (ABR)	
		A-GSFW (Amber)	3.0K-GSFLW				
		R-GSFW (Red)	5.0K-GSFLW				
		Enter 120V Lamp Watts: 120V-					

*1 4" O/C is spaced at 4 1/2" from center to center for cages.



CALIFORNIA ACCENT LIGHTING, INC.
 2034 E. Lincoln Ave. #431, Anaheim, CA 92806
 ph. 800.921.CALI (2254) or 714.535-7900 \ fx. 714.535.7902
 info@calilighting.com \ calilighting.com
 © CALI. All rights reserved. CALI reserves the right to make changes or withdraw specifications without prior notice.



2019.1.07 R3

LAMP OPTIONS

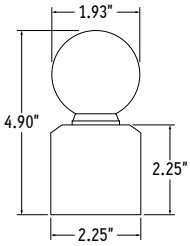

LED Lamp G Shape (#GSF)
360° Beam Angle
20,000 hrs.
80 CRI
42 Lumens
Lamp Temperatures:
2.7K
5.0K
Amber
Red
Green

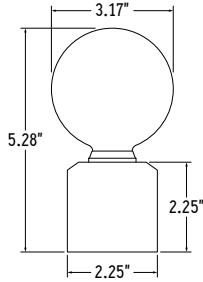

LED Lamp G Shape (#GSFW)
360° Beam Angle
15,000 hrs.
90 CRI
350 Lumens
Lamp Temperatures:
2.7K
5.0K
Amber
Red
Green

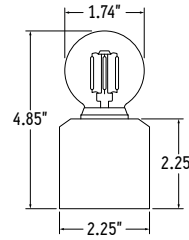

LED Filament Shape (#GSFL)
360° Beam Angle
20,000 hrs.
90 CRI
256 Lumens
Lamp Temperatures:
2.4K
2.7K
3.0K
5.0K

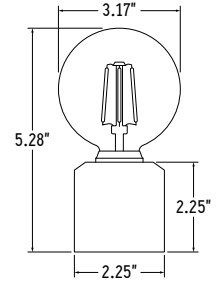

LED Filament Shape (#GSFLW)
360° Beam Angle
15,000 hrs.
90 CRI
350 Lumens
Lamp Temperatures:
2.4K
2.7K
3.0K
5.0K

LAMP SPECIFICATIONS

LAMP SHAPE	DESCRIPTION	TYPE	WATTS (LED)	MAX WATTS	4" O/C	6" O/C	8" O/C	9" O/C	12" O/C
GSF	Polymer Plastic	Frosted	1	600	200'	300'	400'	450'	600'
GSFW	Polymer Plastic	Frosted	3.8	600	52'	78'	104'	117'	157'
GSFL	Clear Glass	Filament	3	600	66'	100'	133'	150'	200'
GSFLW	Clear Glass	Filament	3.8	600	52'	78'	104'	117'	157'
120V	Incandescent Lamp	Clear	Varies by Lamp	1920	Maximum Run Based on Lamp Watts				

ACCESSORIES FOR SHAPES AND CONTINUOUS RUNS (Not Included)

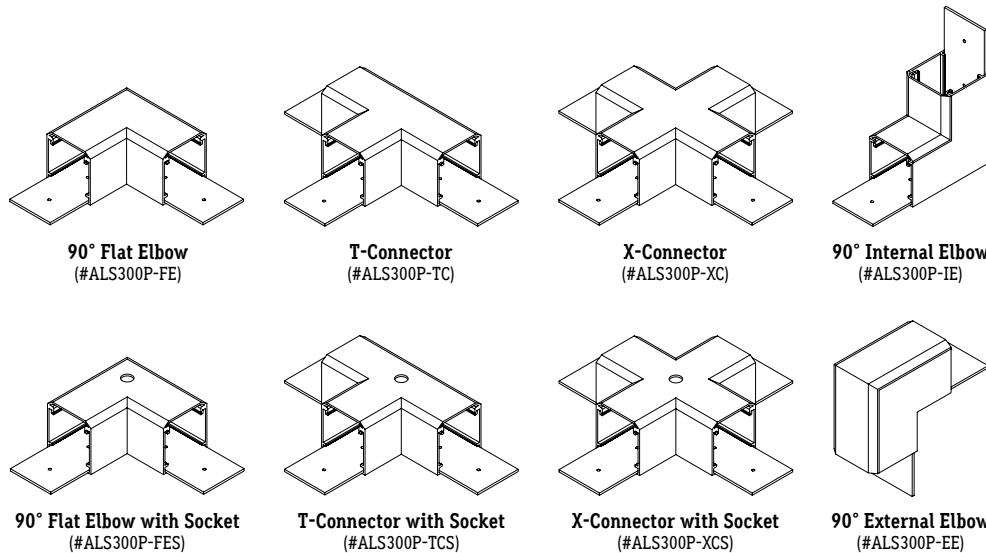

CUSTOM CURVING (Not Included)

